

STATE OF NEW YORK
CONSERVATION COMMISSION
DIVISION OF INLAND WATERS
CHARLTON UNION WATER DISTRICT
GATE HOUSE
AT CHARLTON RESERVOIR
APRIL 1914
G. D. Porter - ASST. ENGR
R. H. Shannon - CHIEF ENGR

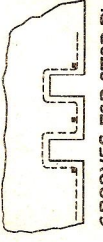

0 1 2 3 FT.

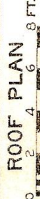
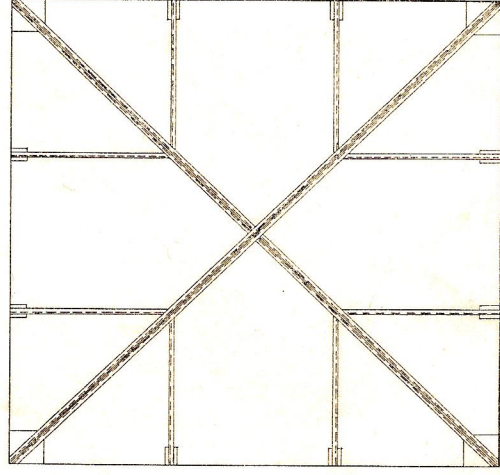
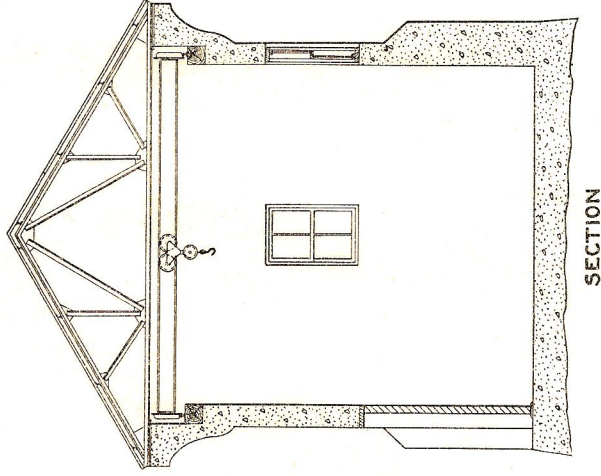